

4

3

2

1

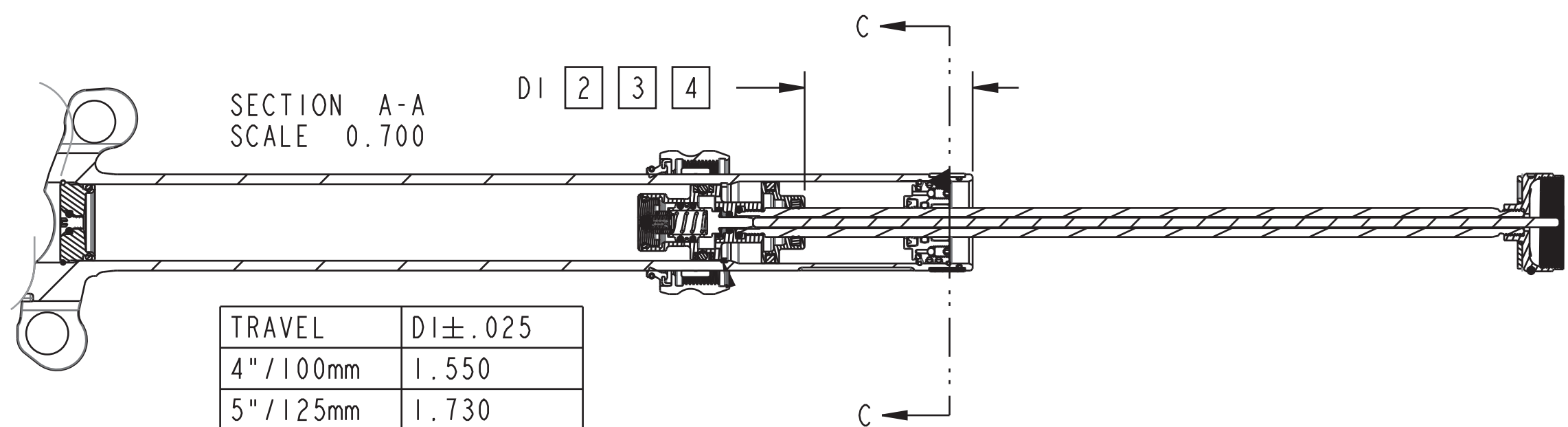

TRAVEL	D1 ± .025
4" / 100mm	1.550
5" / 125mm	1.730
5.5" / 140mm	1.797
6" / 150mm	1.890
7" / 175mm	2.070
8" / 200mm	2.220

- 2 SET IFP HEIGHT PER TABLE.
- 3 ADD 0.5cc TO 1cc OF FLOAT FLUID TO IFP CHAMBER
- 4 SET IFP NITROGEN PRESSURE TO 325±10 PSI.

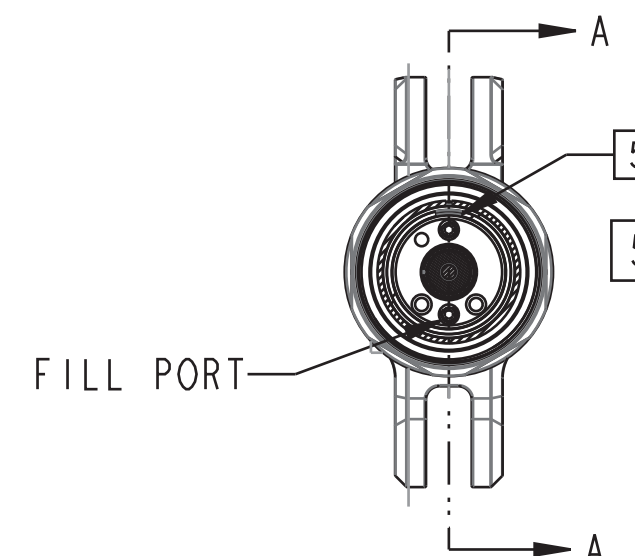
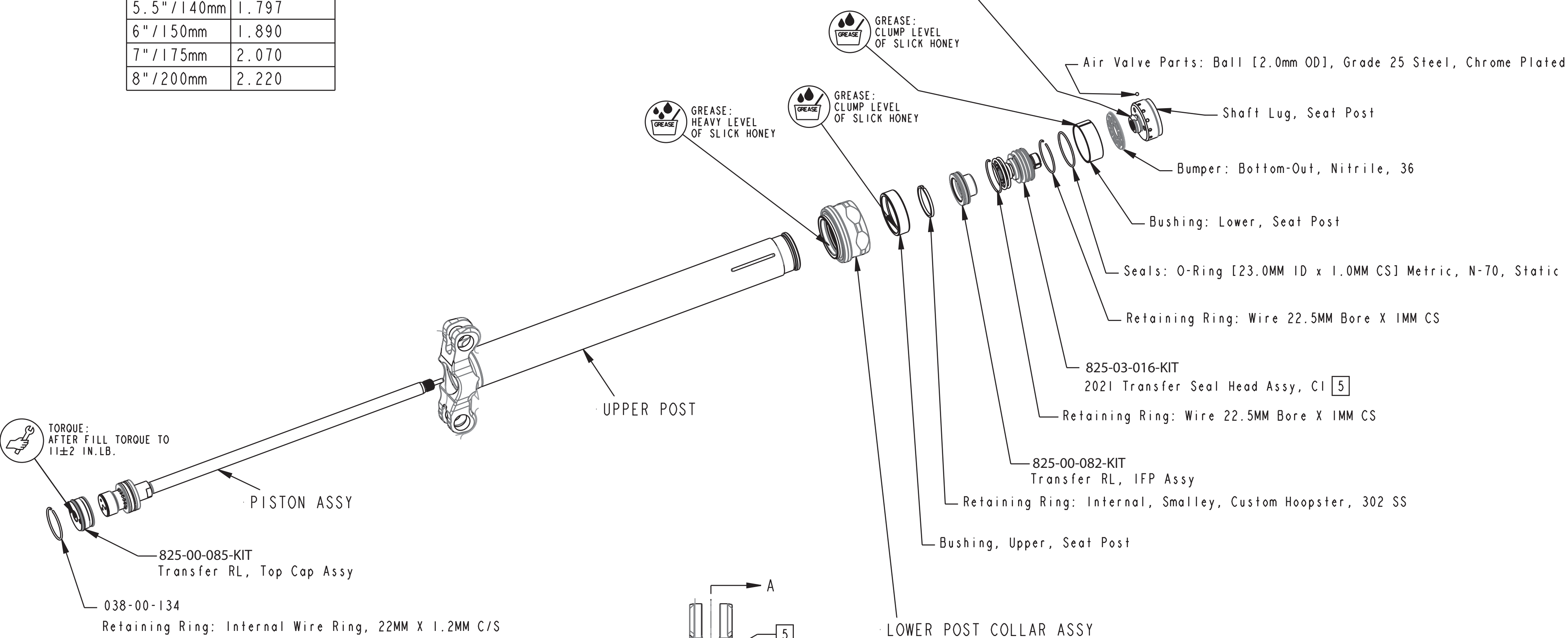

5 SEAL HEAD FILL PORT SHALL BE POSITIONED 180° FROM RETAINING RING SPLIT AFTER INSTALLATION.

**FOX Factory, Inc.**  
 130 Hangar Way, Watsonville, CA 95076 USA  
 Ph 831-768-1100 Fax 831-768-9312

TITLE  
**2024 Transfer / Turbine R  
 Upper Post Assys**

SIZE DWG. NO.  
**C**

PLOT SCALE 0.70:1 SHEET 1 OF 1

PROPRIETARY - THIS DOCUMENT CONTAINS CONFIDENTIAL, PROPRIETARY INFORMATION THAT IS FOX PROPERTY. DO NOT DISCLOSE TO OR DUPLICATE FOR OTHERS EXCEPT AS AUTHORIZED BY FOX.

4

3

2

1

ProE ASSEM